

# Stainless Steel Filtration Apparatus



SF 10



SF 30

## Features

- ▶ Spin-lock connection (M577346) facilitates fast and stable installation without clamp.
- ▶ SS316 funnel is shatterproof, durable and can be fast sterilized by flame.
- ▶ Built-in overflow protection to keep the filtrate from overflowing when waste bottle is full.

## Applications

General filtration, such as medium purification, microbiological test etc.

## Specifications

Material	SF 10	SF 30
Funnel	SS316	SS316
Support base	SS316	SS316
Membrane support	SS316	SS316
Receiver bottle	PC	PC

## Specifications

Funnel capacity	100 ml	300 ml
Bottle capacity	1200 ml	1200 ml
Filter diameter	47 mm	47 mm
Hose barb	ID8	ID8
Overflow protection	Yes	Yes

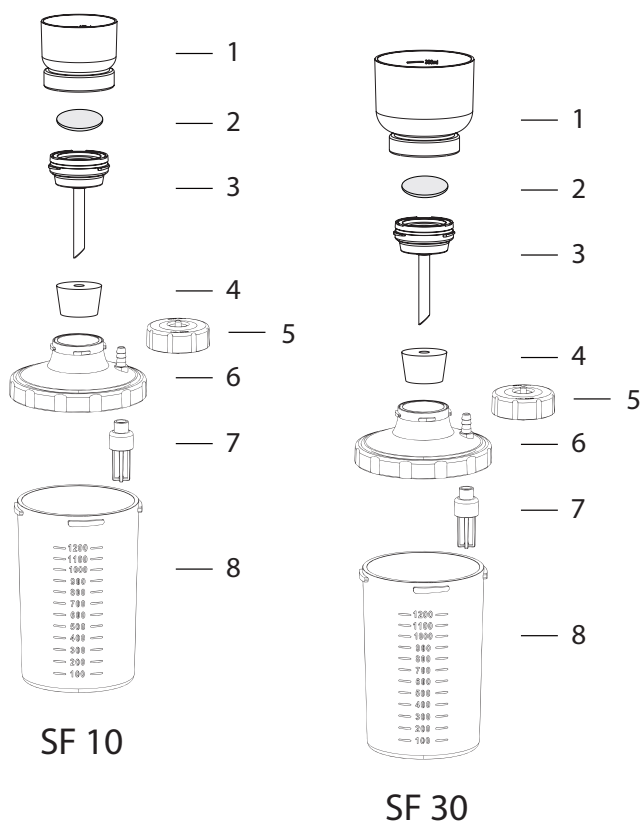

## Ordering Information

### SF 10, Stainless Steel Filtration Set 197010-32

1	Stainless steel funnel, 100 ml	180100-01
2	Stainless steel support screen	180100-31
3	Stainless steel support base	180100-00
4	Silicone stopper (No.16)	167110-17
5	Black PP cap	197000-40
6	PC cover	197000-32-PC
7	Overflow protection	197000-39
8	PC bottle, 1200 ml	197000-31-PC

### SF 30, Stainless Steel Filtration Set 197010-33

1	Stainless steel funnel, 300 ml	180100-03
2	Stainless steel support screen	180100-31
3	Stainless steel support base	180100-00
4	Silicone stopper (No.16)	167110-17
5	Black PP cap	197000-40
6	PC cover	197000-32-PC
7	Overflow protection	197000-39
8	PC bottle, 1200 ml	197000-31-PC



# Stainless Steel Filtration Apparatus



SF 11



SF 52

## Features

- ▶ Spin-lock connection (M577346) facilitates fast and stable installation without clamp.
- ▶ SS316 funnel is shatterproof, durable and can be fast sterilized by flame.
- ▶ Drains the filtrate away directly without removing the tubes.

## Applications

General filtration, such as medium purification, microbiological test etc.

## Specifications

Material	SF 11	SF 52
Funnel	SS316	SS316
Support base	SS316	SS316
Membrane support	SS316	SS316
Stopper	Silicone rubber	Silicone rubber
Receiver flask	Borosilicate glass	Borosilicate glass
Drain hose	Rubber (non-autoclavable)	Rubber (non-autoclavable)

## Specifications

Funnel capacity	100 ml	500 ml
Flask capacity	1000 ml	2000 ml
Filter diameter	47 mm	47 mm
Hose barb	ID8	ID8
Drain device	Yes	Yes

\*The flask withstands nearly full vacuum for use in vacuum filtration.

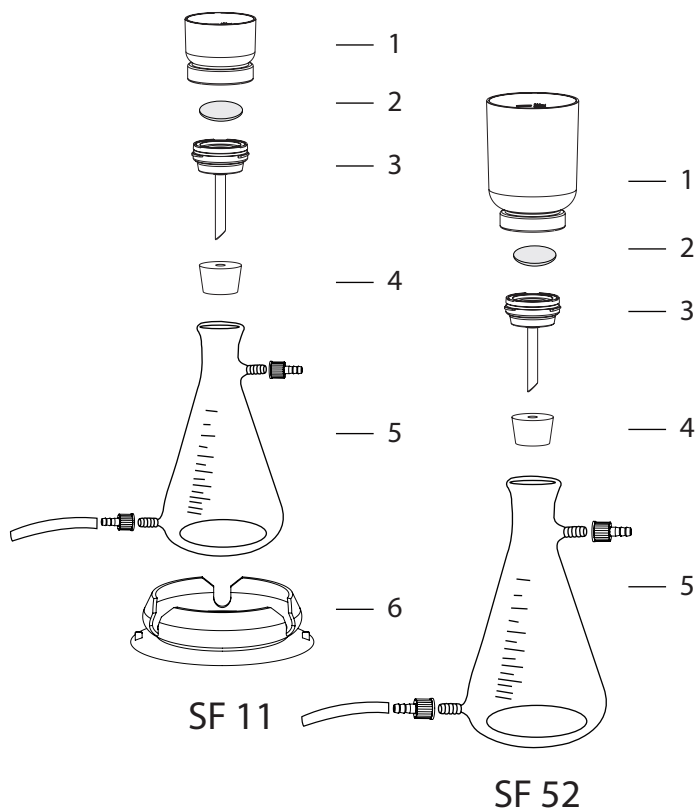

## Ordering Information

SF 11, Stainless Steel Filtration Set		167200-02
SF 1, Stainless Steel Filter Holder (100 ml)		180100-10
1	Stainless steel funnel, 100 ml	180100-01
2	Stainless steel support screen	180100-31
3	Stainless steel support base	180100-00
4	Silicone stopper (No.8)	167110-16
5	Receiver flask with drain, 1000 ml ( with screwthread connector )	167300-08
6	Silicone fixing sucker	167200-45
SF 52, Stainless Steel Filtration Set		167200-11
Stainless Steel Filter Holder (500 ml)		
1	Stainless steel funnel, 500 ml	180100-05
2	Stainless steel support screen	180100-31
3	Stainless steel support base	180100-00
4	Silicone stopper (No.18)	167110-18
5	Receiver flask with drain, 2000 ml ( with screwthread connector )	167200-13